

WEARwatcher CAT5 Direct and Multiple Suspension

The WEARwatcher CAT5 configuration drives complete monitoring of the physical parameters of the lift.

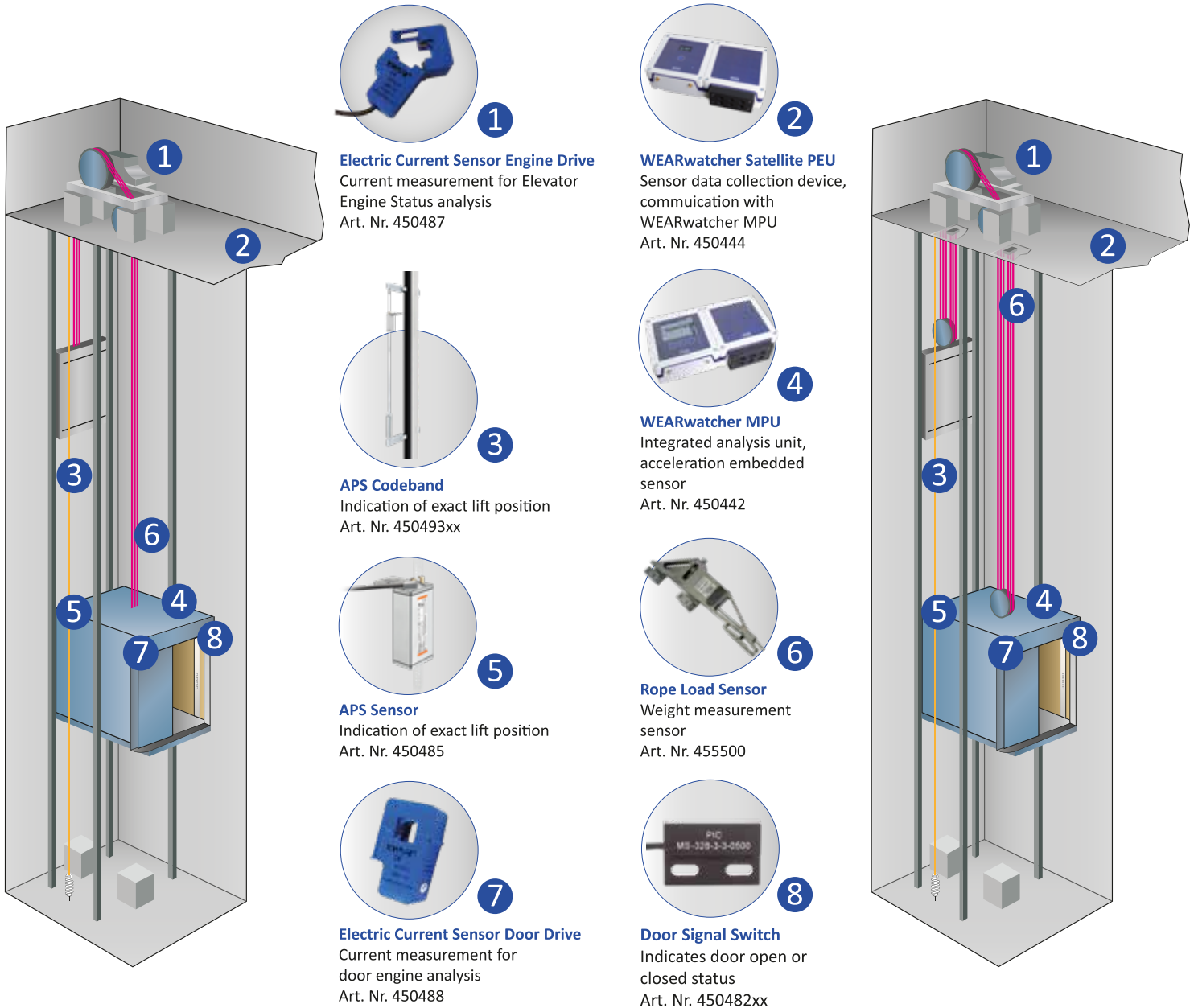

WEARwatcher Features

- | | | | |
|-----------------------|--------------------------|---------------|-------------------------|
| Breakdown probability | Ø Speed | Guides | Hoistway doors |
| Duty cycles | Ride quality | Drive | Car doors |
| Ride distance | Ø Number of rides | Vibrations | Grooves |
| Ø Drive time | Load conditions | Twisted ropes | Wear of ropes |
| Door cycles | Door reversion detection | UCM warnings | Emergency stop analysis |
| Levelling precision | Shaft efficiency | Sheaves wear | Traction monitoring |